

# CaBano

## #6067

H3O ceiling rain head

### INSTALLATION GUIDE



Last revision: October 23rd

### ■ Installation Diagram:

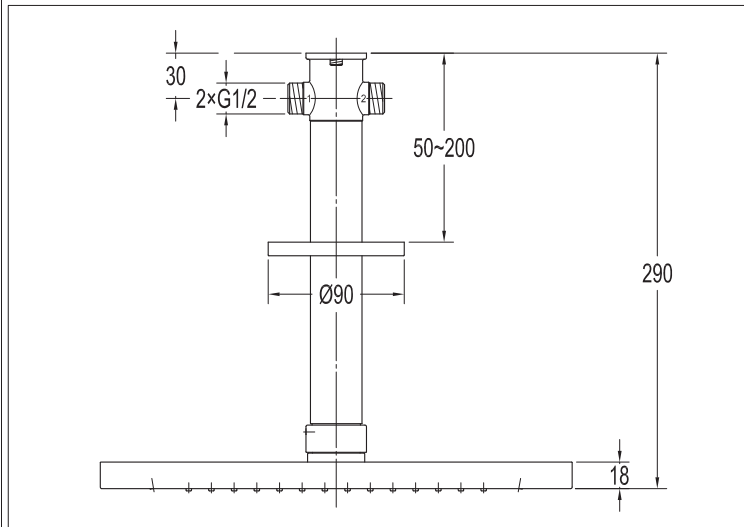

### ■ Installation Steps ( Fig. 1~12 ) \*The installation diagram is only for reference, the product is subject to the real object.

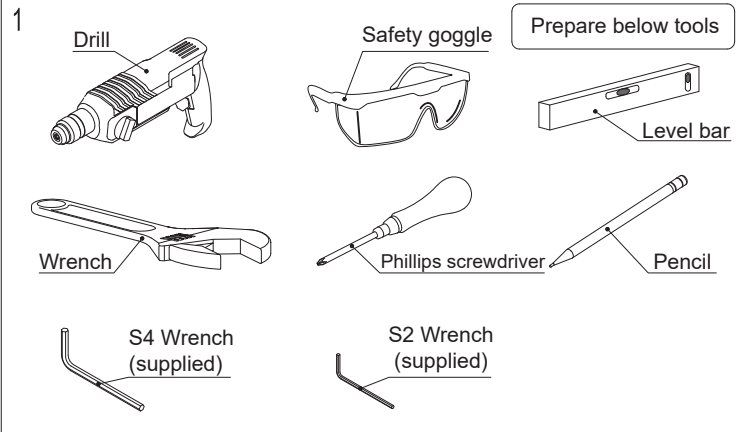

### I. Installation Notice

1. Floor drain should be installed on the site.
2. Mixers, except the shower arm, should be installed only after the completion of house interior decoration in case paint or other chemicals erode the mixer surface. Before that, the protective cover must not be removed and the rest of the shower arm should be good protected.
3. Clean pipes to get rid of mud, sand or other debris blocked in pipes before installation.
4. Check whether the threads can be matched. Otherwise, install forcefully will damage the components.
5. After installation, check all the joints to make sure they are firmly connected. Then keep water flow. Check all the joints again to ensure no leaking problem. After that, the product is ready for normal use.
6. Hand the manual to users.

### II. Operation Notice:

1. The product is used under water pressure 0.05~0.5MPa, water temperature 4~70°C.
2. Do not hang heavy things on the product.
3. Remember to turn off the mixer when no water comes out of it, especially when nobody in the house or during the decoration period or power off.
4. Clean the surface of the product regularly to keep it bright.  
Note: Please do not use inappropriate tools such as sharp brushes, rough sponges, scouring pads or corrosive detergent. And it is not recommend to use the detergent sold in the market, because its formula changes frequently. Please clean the product with wet cloth and soapy water after some time of usage. Then rinse the soap out with clean water and dry with a soft cotton cloth.
5. Adjust the temperature before use. To avoid scald, do not stand right below the shower head.
6. Do not disassemble the product without help from the professionals.

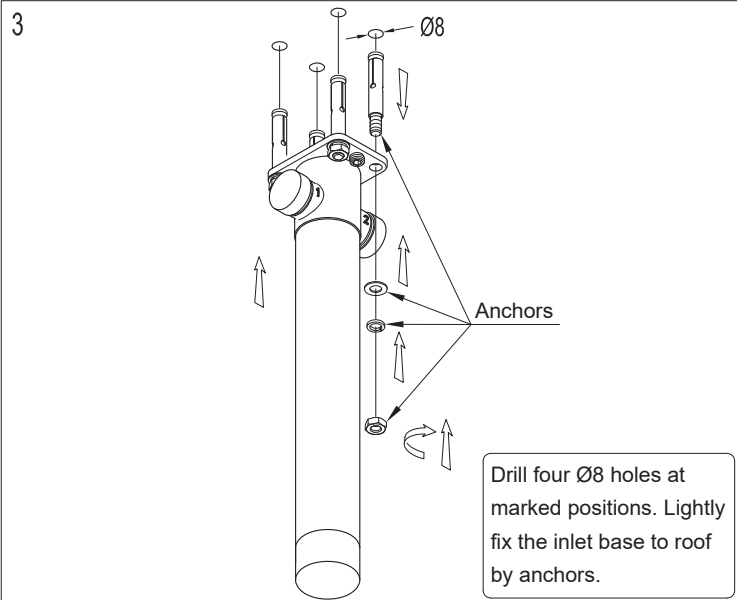
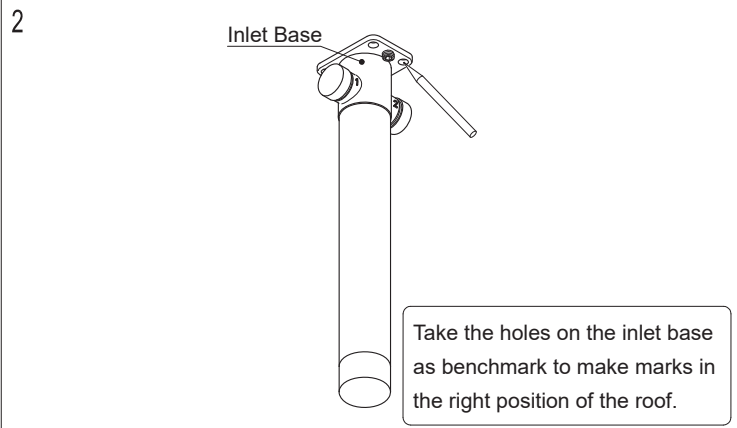

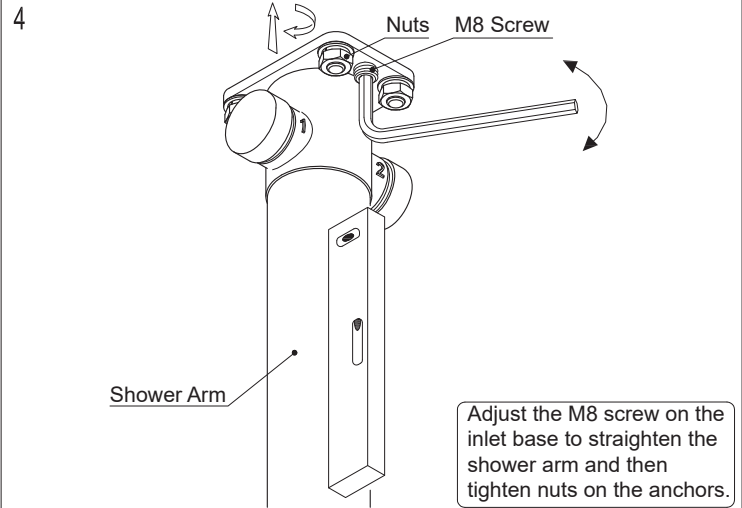

Adjust the M8 screw on the inlet base to straighten the shower arm and then tighten nuts on the anchors.

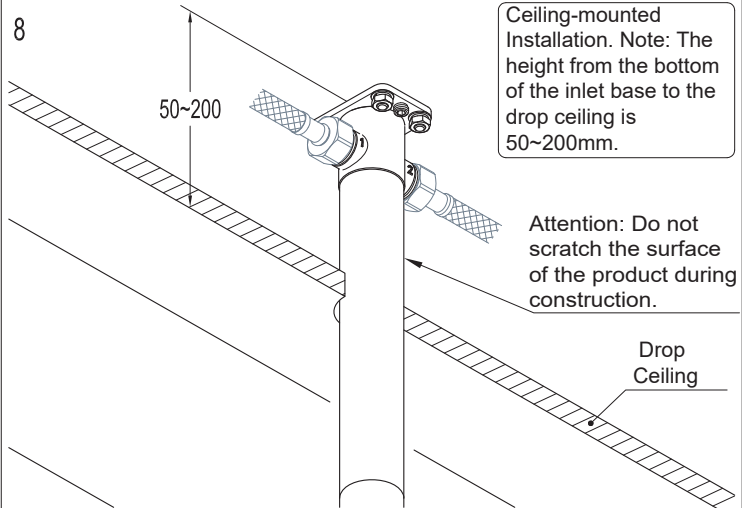

Ceiling-mounted Installation. Note: The height from the bottom of the inlet base to the drop ceiling is 50~200mm.

Attention: Do not scratch the surface of the product during construction.

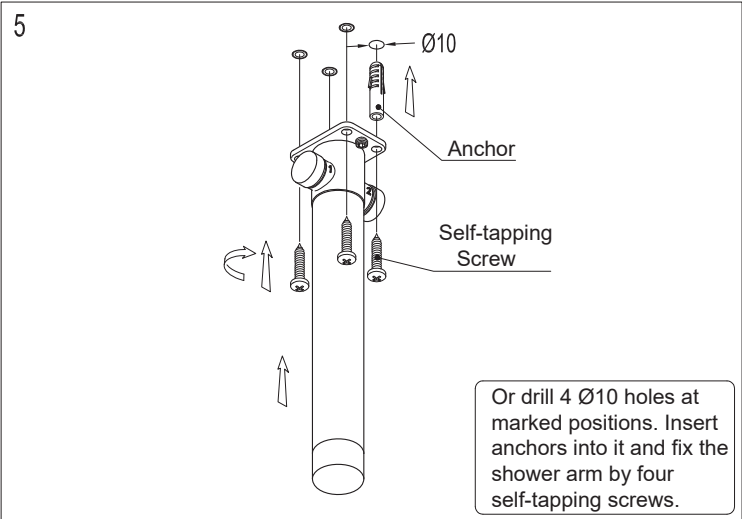

Or drill 4 Ø10 holes at marked positions. Insert anchors into it and fix the shower arm by four self-tapping screws.

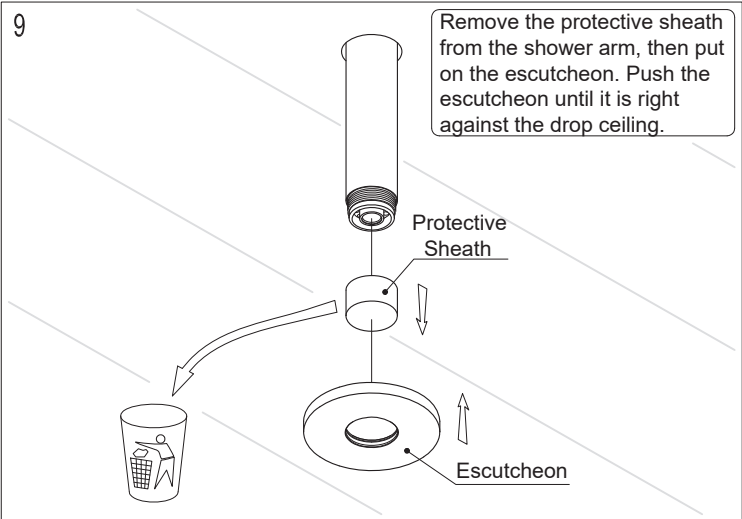

Remove the protective sheath from the shower arm, then put on the escutcheon. Push the escutcheon until it is right against the drop ceiling.

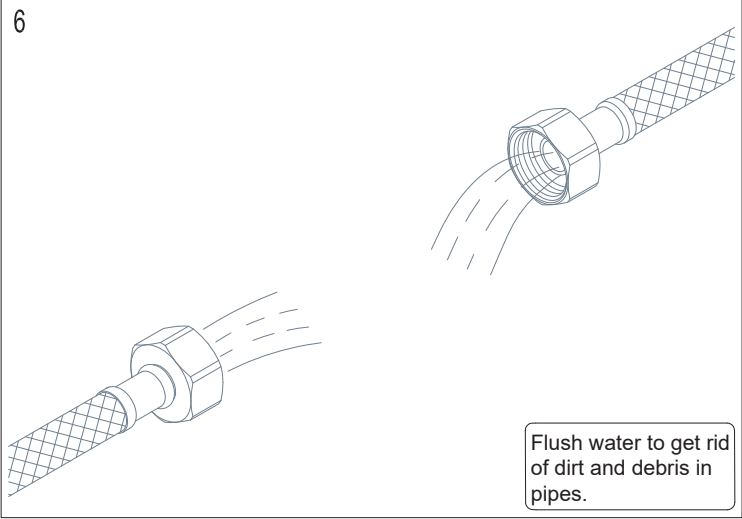

Flush water to get rid of dirt and debris in pipes.

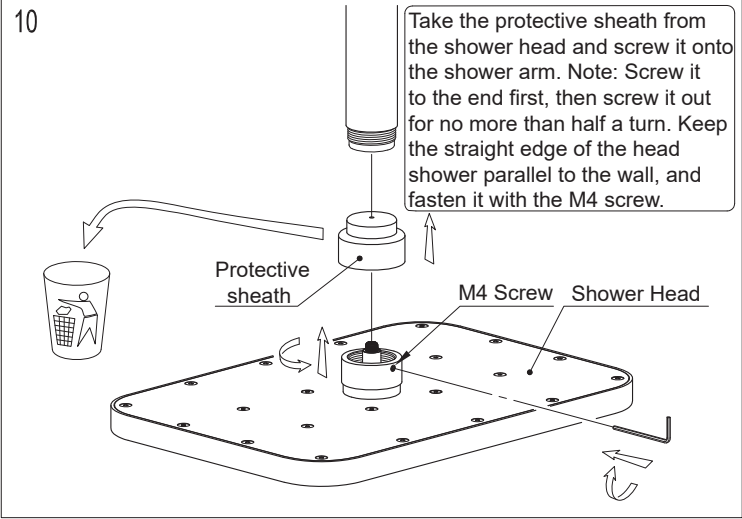

Take the protective sheath from the shower head and screw it onto the shower arm. Note: Screw it to the end first, then screw it out for no more than half a turn. Keep the straight edge of the head shower parallel to the wall, and fasten it with the M4 screw.

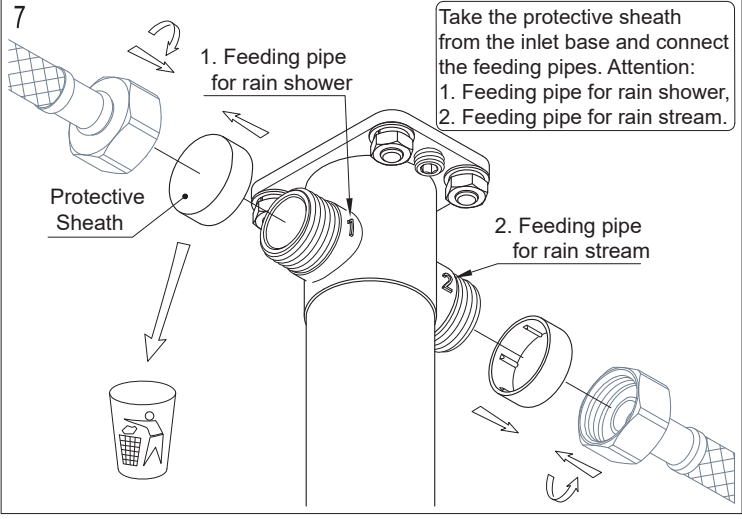

Take the protective sheath from the inlet base and connect the feeding pipes. Attention: 1. Feeding pipe for rain shower, 2. Feeding pipe for rain stream.

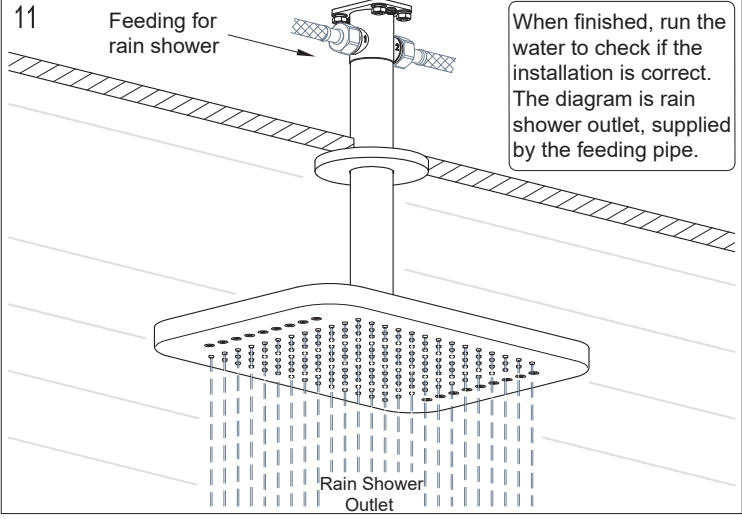

When finished, run the water to check if the installation is correct. The diagram is rain shower outlet, supplied by the feeding pipe.

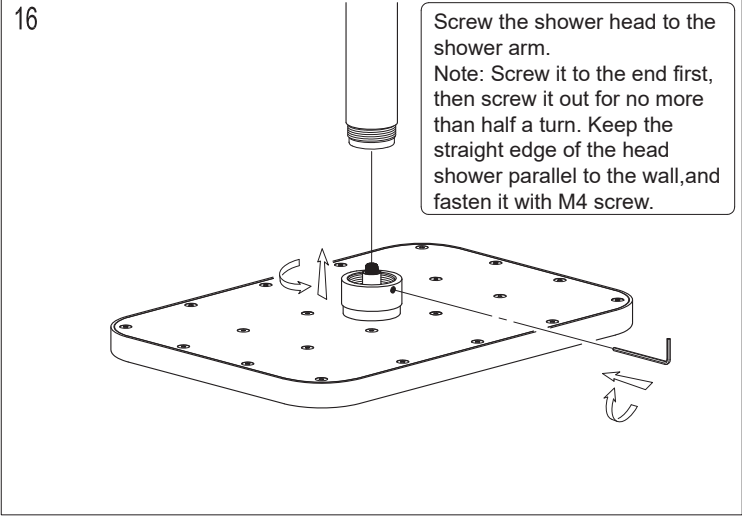
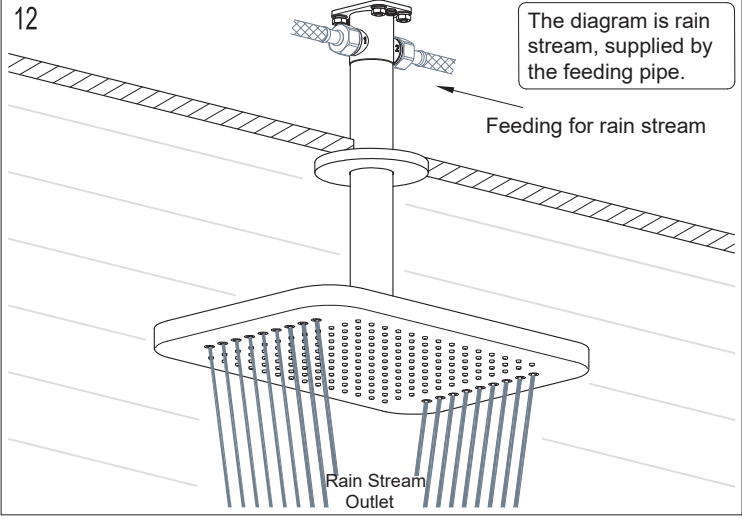

**V. Maintenance**

If flow rate is lessened after a period of usage, it is possibly because debris blocks the filters due to poor water quality. Cleaning method should be taken as followed. First, turn off the main valve. Take off the rainshower as shown in the Diagram 13 and 14. Use brush and vinegar to remove dirt and debris from small filters and holes, and rinse with clean water. Then use flush water to get rid of dirt and debris in pipes (Diagram 15), and install the rainshower back like Diagram 16. Check the flow volume. If it is still not right, take off the rainshower and shower arm as shown in Diagram 13 and 17. Clean up the dirt on the filter of the shower arm and finally put them back like Diagram 18 and 16.

If water flow from the rainshower becomes lessened or does not spray evenly, it might be due to debris blocking the outlet. Gently squeeze those rubber outlets on the rainshower with fingers as shown in Diagram 23. Then wash debris out with running water.

